



Weight Bar Cap Replacement Instructions for Starling Tab-Tension 2 Series

For technical support or further assistance, call 877-511-1211 x604

ATTENTION: Elite Screens does not recommend making unnecessary adjustments to the screen, as **improper adjustments will damage** the unit and **void your warranty**.

1. Using a Philips head screw driver, remove the 2 screws securing the cap on the weight bar

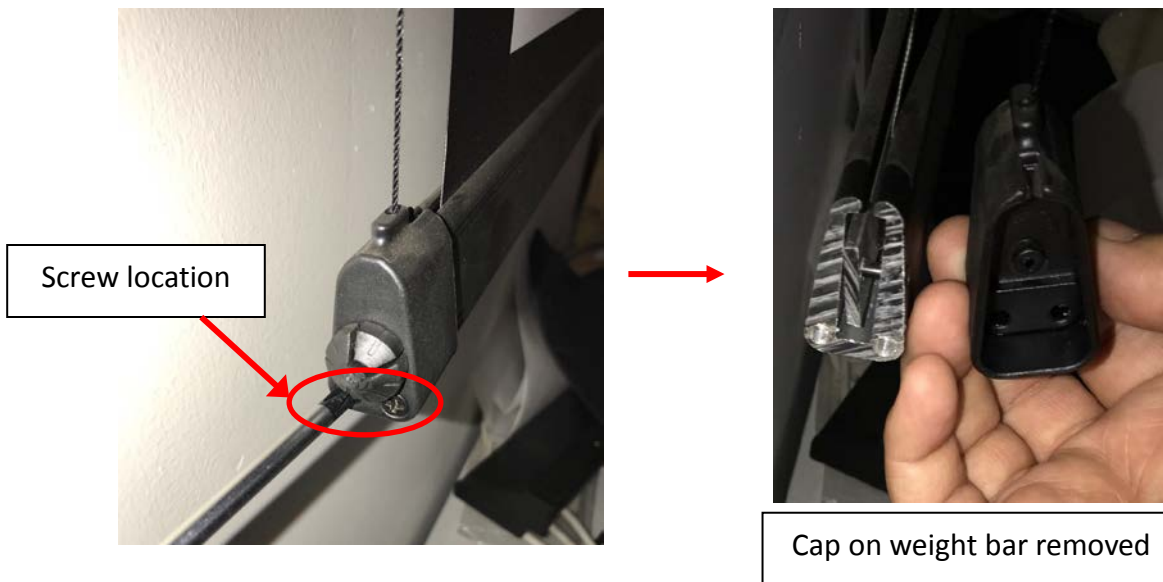

2. Next, remove the U washer from the center rod by prying it out with a flat head screwdriver.



3. Once the washer is removed, you can now remove the back plate of the cap.
4. Once the back plate is removed, you can unwind the string as shown in the picture on the right.

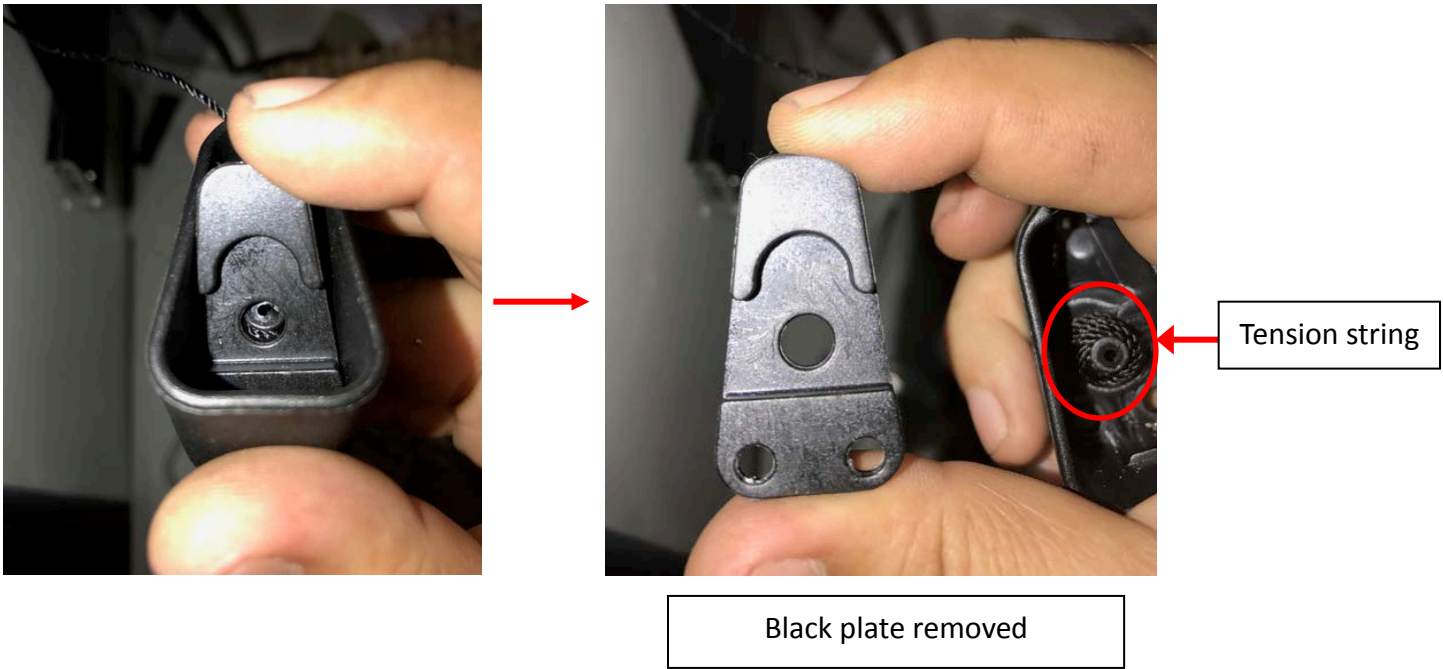

5. After unwinding the string, you can pull out the knob. Be aware that the face plate will fall off.

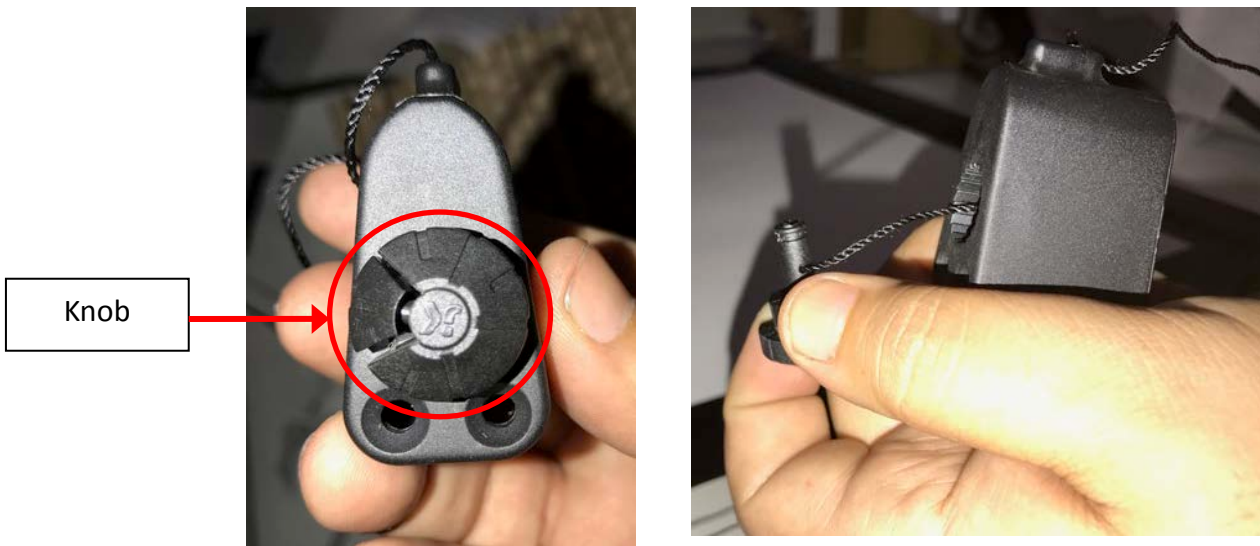

6. A Lastly, untie the knot that tightens the string to the knob. This will then allow for you to pull out the broken weight bar cap.
7. To install the new cap, simply follow these instructions in reverse order.

For a local Elite Screens contact or Technical Support, please visit

www.elitescreens.com