

Congratulations on your new **Dark Star® Special Edition** purchase! The screen material included is our **ISF certified Dark Star® 9** which is a reference quality front projection material, precisely formulated for environments with minimal control over room lighting. It was designed to enhance picture brightness, offer accurate color fidelity, and improve contrast levels. The **Dark Star® 9** is best for family rooms, educational facilities, conference rooms or any applications in which incident light is a factor.

Cautionary notice for the Dark Star® 9 material

The Dark Star Fixed Frame Screen material is composed of high quality sensitive multi-layer projection material. Please follow the precautions below for proper care procedures and to prolong the life of your screen.

Failure to use [these safeguards] will result in voiding your warranty.

1. Avoid using any chemical compounds or harsh abrasives which will result in permanently damaging the screen material.
2. Use only a soft microfiber cloth with mild soap and water to clean the screen material.
3. Please wear a pair of clean, powder-free glove in the process of installing and operating the screen to keep hand oil and dirt from being transferred to the viewing surface.
4. Be very careful when unrolling and handling the material. Lay the material flat only to avoid permanently creasing the material.
5. Do not rub the cloth with force when cleaning to avoid permanently scratching the surface.
6. Do not touch the screen surface with sharp objects or allow the screen surface to come in contact with anything other than the frame.
7. Use only a soft feathered brush to remove dust.
8. Dark Star® 9 material damaged in handling, installation, or use is not covered under warranty.

Frame Parts List

A. Vertical Frame x 2pcs



B. ½ Horizontal Frame x2 pcs

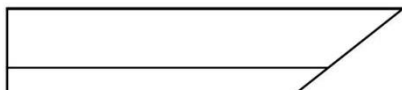

C. ½ Horizontal Frame x 2 pcs

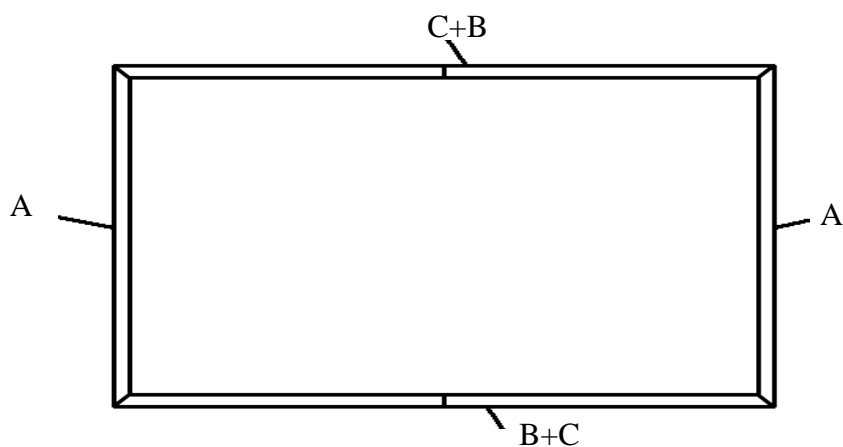
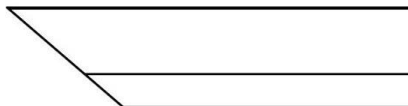

Hardware Parts List

a. M4*4

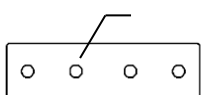

b. D5*4

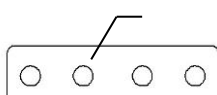

c. M4*4

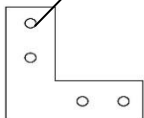

d. D5*4

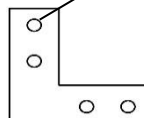

e.

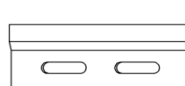

f.

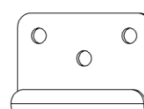

g.



h.

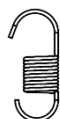

i.



k.



l.



o.



p.



Item	Parts List	106"	122"	156"
a.	Center Joints- M4 (bottom position)	2	2	2
b.	Center Joints-D5 (top position)	2	2	2
c.	Elbow Joints M4 (bottom position)	4	4	4
d.	Elbow Joints D5 (top position)	4	4	4
e.	Top hanging brackets	2	2	2
f.	Bottom brackets	2	2	2
g.	M4x7 Screws	24	24	24
h.	Spring	98	112	136
i.	Pull Hook	2	2	2
k.	Wall Screws M5x50	8	8	8
l.	Hollow Wall anchors	8	8	8
p.	White gloves	2	2	2
o.	Center Support Bar	1	1	2

Frame Assembly

Step 1: Place the EPE sponge (foam) sheet on the ground of the area where the screen will be assembled.

Step 2: Position the pieces of the frame on the EPE sponge in the arrangement shown below.

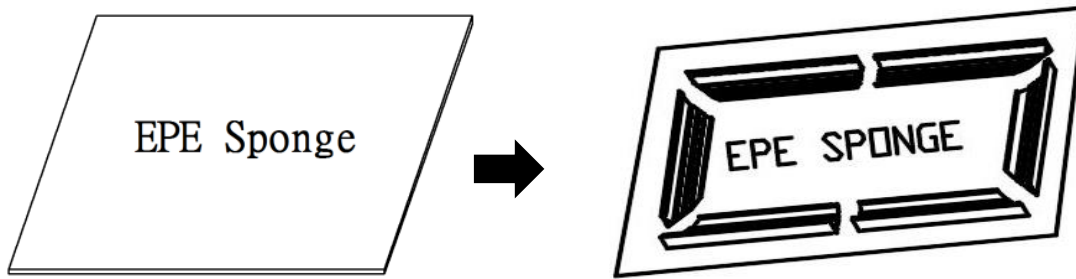

Step 3: Insert center joint (a/b) connectors into one-half of the horizontal frame (B/C) and secure with the M4x7 screws (g) as shown in the illustration below.

Tip: The center joint (d) with the larger diameter holes should be on top.

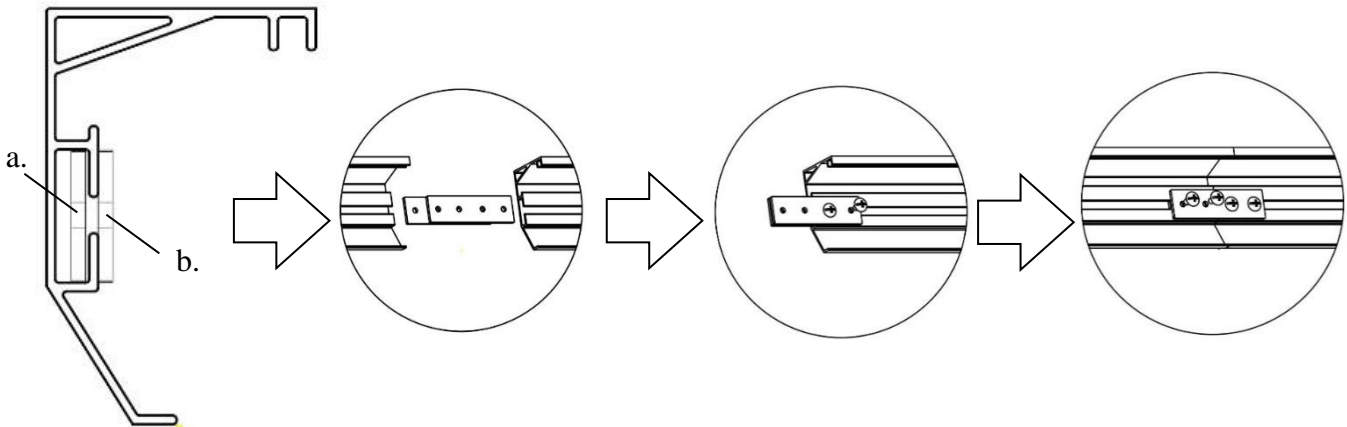

Step 4: Connect the elbow joints (c/d) to the top and bottom sections of the vertical frame. Once inserted, connect the vertical sections to the horizontal frame sections. Make sure all holes are in alignment and the frame pieces are flush (no gaps). They should form perfect right angles.

Tip: The elbow joint (d) with the larger diameter holes should be on top.

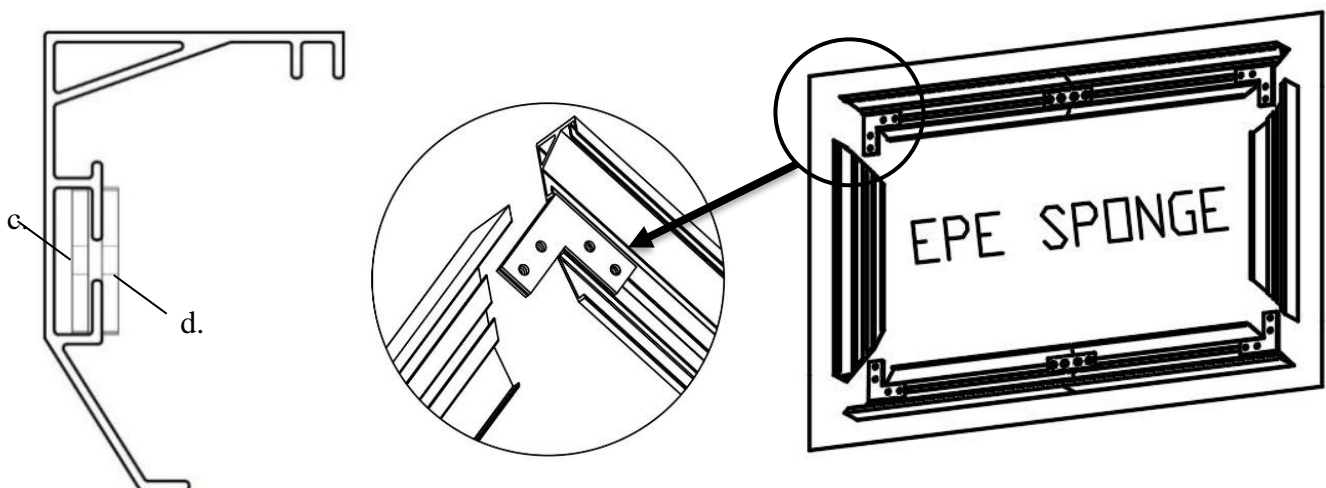

Step 5. Secure the elbow joints by fastening them with **M4x7 screws (g)**, 4 at each corner.

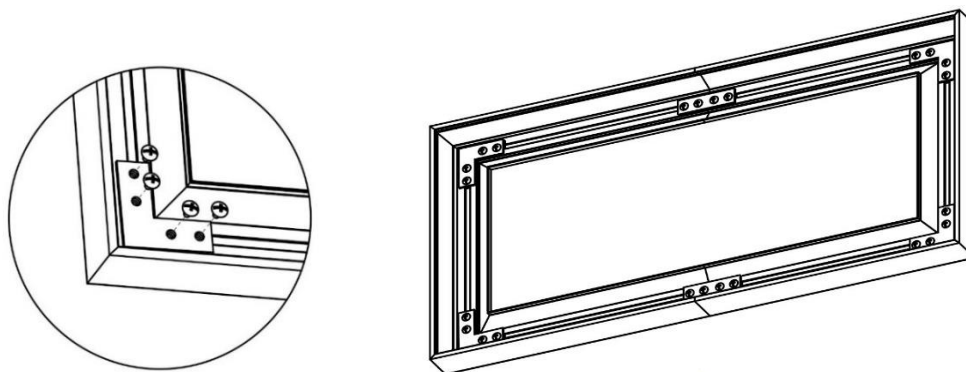

How to attach the springs

Step 6. Hook one end of the spring and secure inside the groove of the frame, use the **spring hook (i)** to attach the spring to the hole located on the screen material's outer edge in the following order.

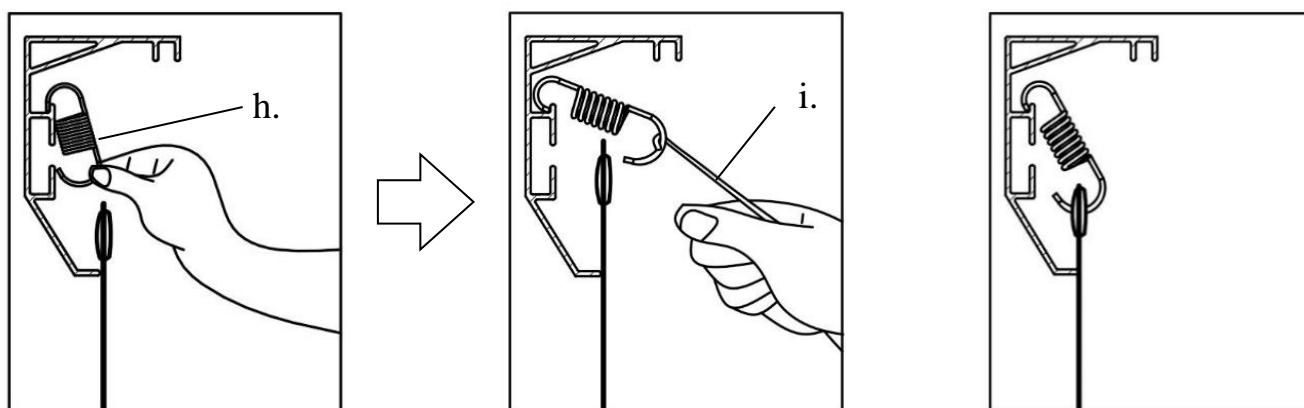

Screen Material

Step7. Carefully unroll a small area of the material over the frame as shown below and secure the top and bottom corners by hooking them with two springs on the corner of the material (1), Then hook and secure the springs in the middle (2). **Note: Backside is black**

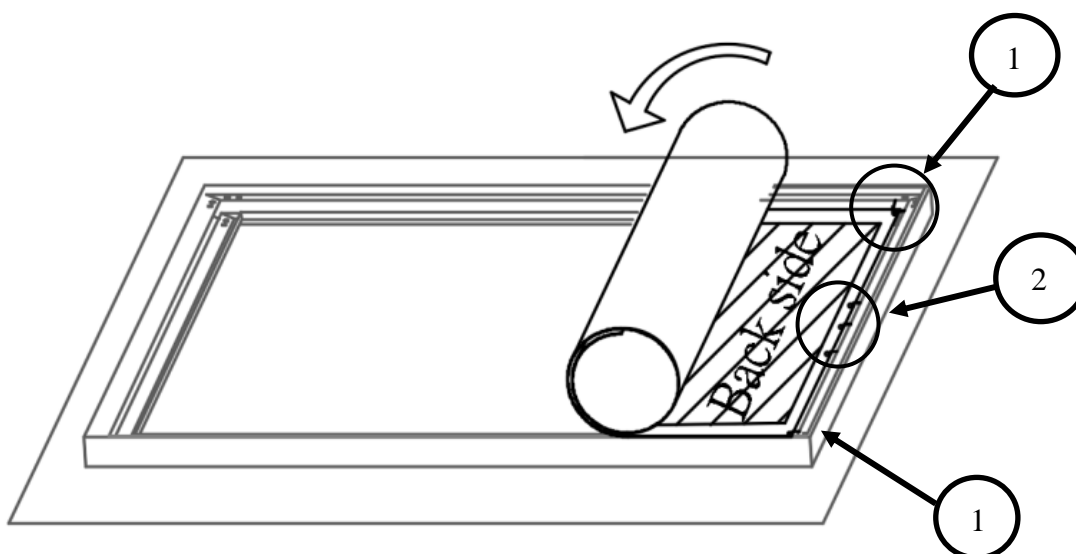

Carefully unroll the material to the middle area then hook the springs on both the top and bottom (3). Continue unrolling the entire material to the other end, hook the springs in the corners (4) and hook the springs in the middle (5).

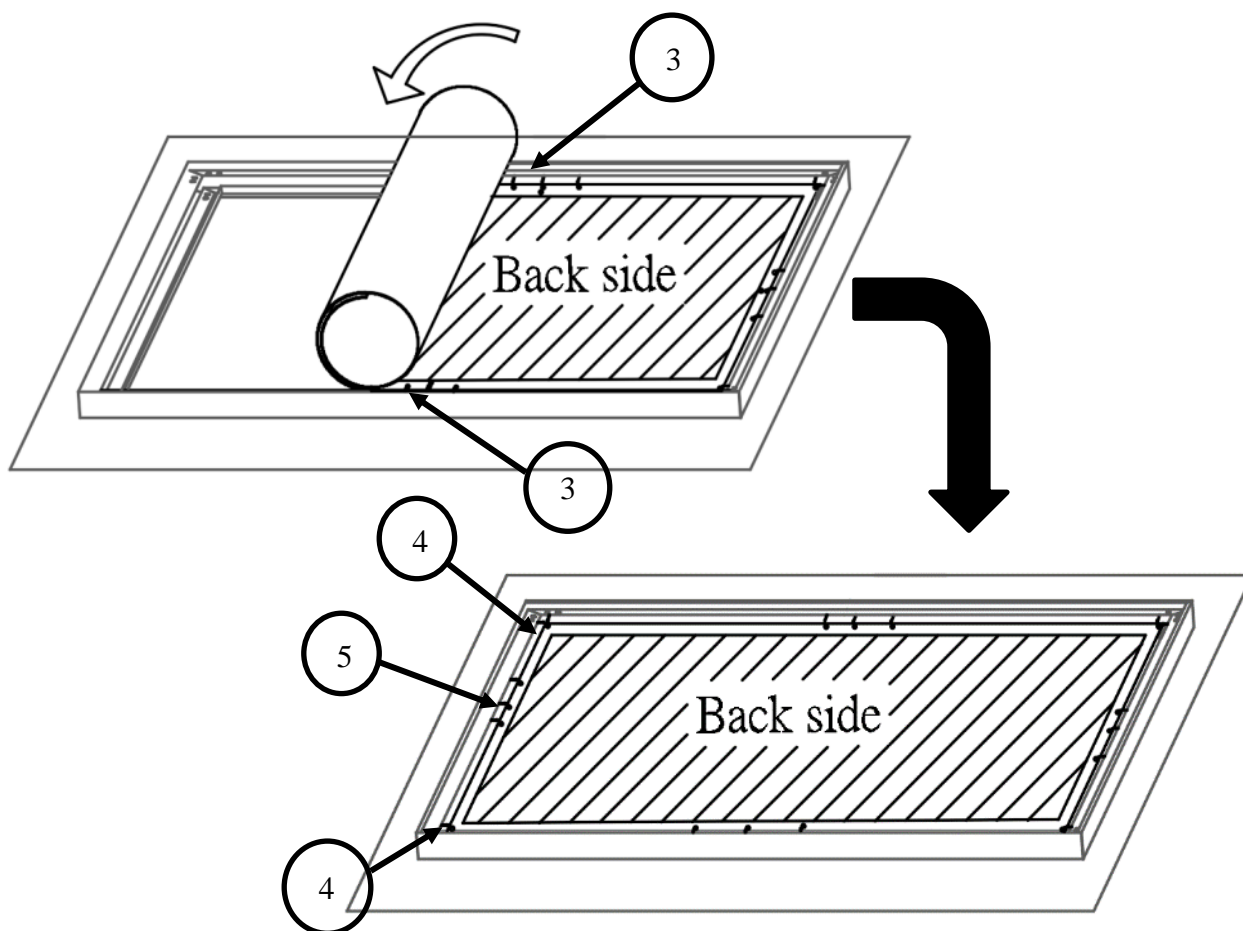

Continue to attach the remaining springs to the material in steps 6-13 in the following order

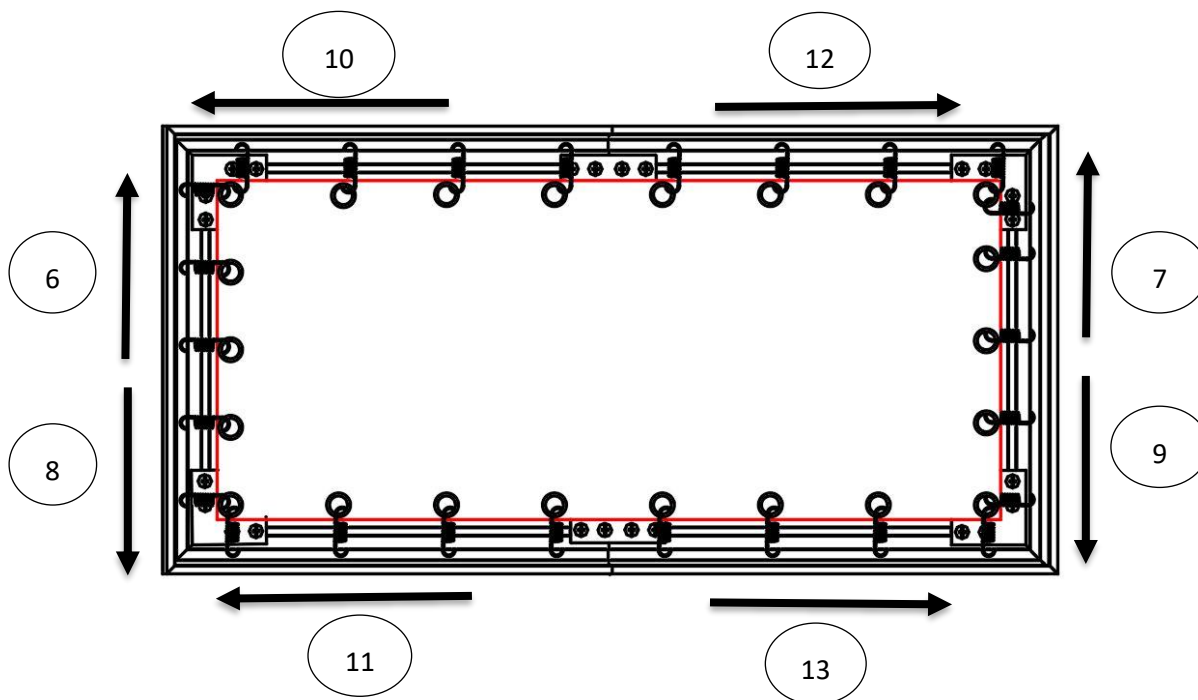

Step 8. Insert the Center Support Bar (o) into the upper top groove on the back of the frame with the bottom end near the approximate center point of the frame and rotate it in at an angle so that both ends of the bar are in alignment with the groove.

Diagonal Models 150" and below use 1 x Center Support Bar

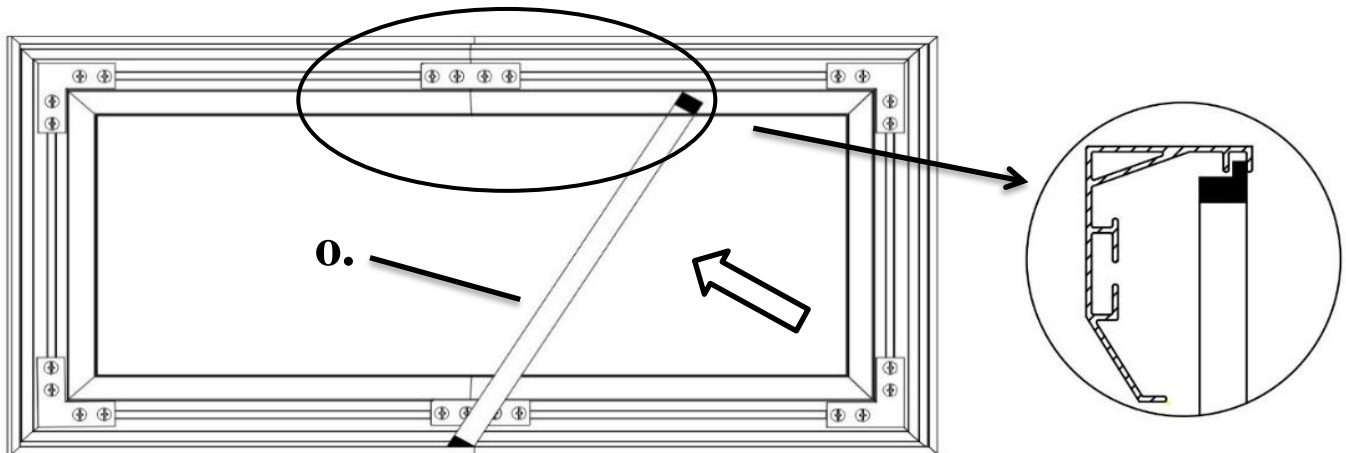

Diagonal Models above 150" require 2 x Center Support Bars

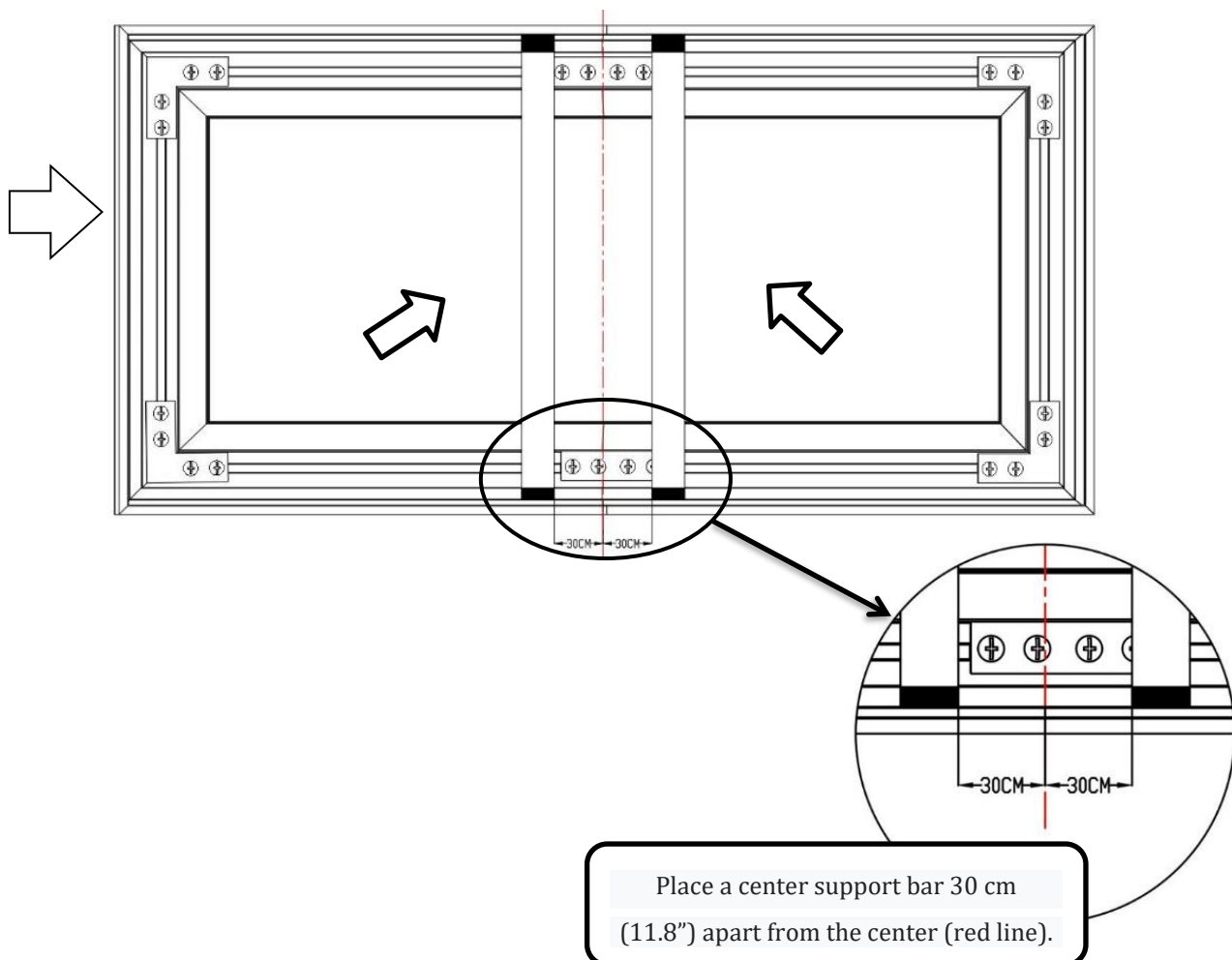

Notice to Installer:

Please use the following installation instructions to obtain superior optical performance from the Retro Reflective ALR (Ambient Light Rejecting) Dark Star® 9 Screen.

The following guidelines should also be followed.

1. Minimum throw distance of 1.5 x the image width
 - Avoid a *hotspot* effect
 - **Light absorption** – The angle of incident light is too steep and will get absorbed by the optical lenses. This will create a very dim image and affect the overall picture quality.
2. **Ambient light** should not come from the same direction as the projector's light

Proper projector placement

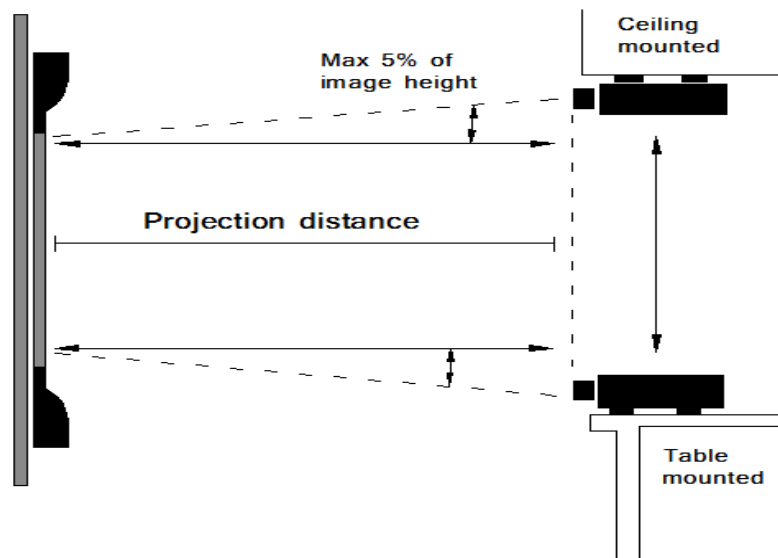

Image is not up to scale and is for illustrations purposes only.

Note: Do not install the projector at an angle that is greater than 5° off the vertical axis from the screen. The ambient light filtration layer in the material is designed to absorb off-axis light rather than reflect it.

Installation

Step 9. Measure the overall length and height of the frame and drill holes for the top brackets. Line up the wall brackets with the drilled holes on the installation location and screw them in using a Phillips screwdriver. If not installing into a structural wood stud, use a hollow wall anchor then screw in the M5x50 wood screws with a screwdriver.

Make sure the brackets are leveled.

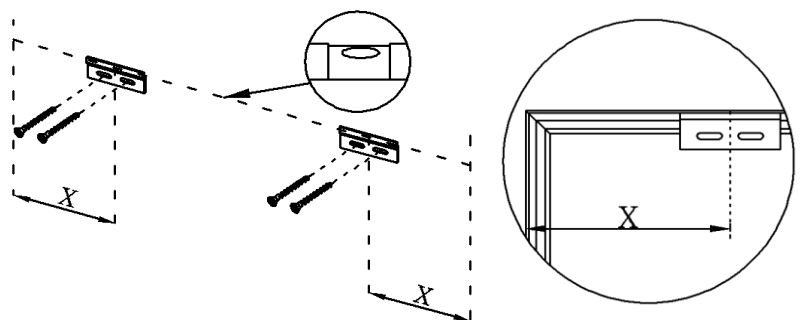

Step 10. Position the fixed frame screen onto the top wall brackets as shown below and push down at the center of the top of the frame to secure.

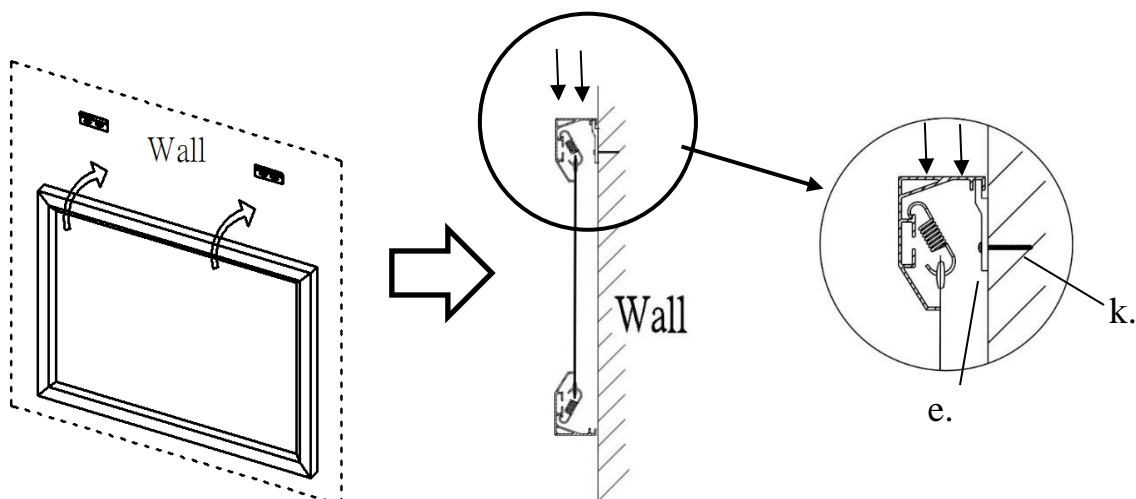

Step 11. With the frame slightly tilted outward; connect the bottom brackets onto the bottom groove of the frame. Slowly return the screen to a normal upright position. Once the screen is flush to the wall, secure the brackets to the wall with a screw. If not installing into a structural wood stud, mark the sites where the hollow wall anchors will be placed using the same instructions above. With the wood anchor installed, repeat the process and fasten the brackets with the M5x50 wood screws.

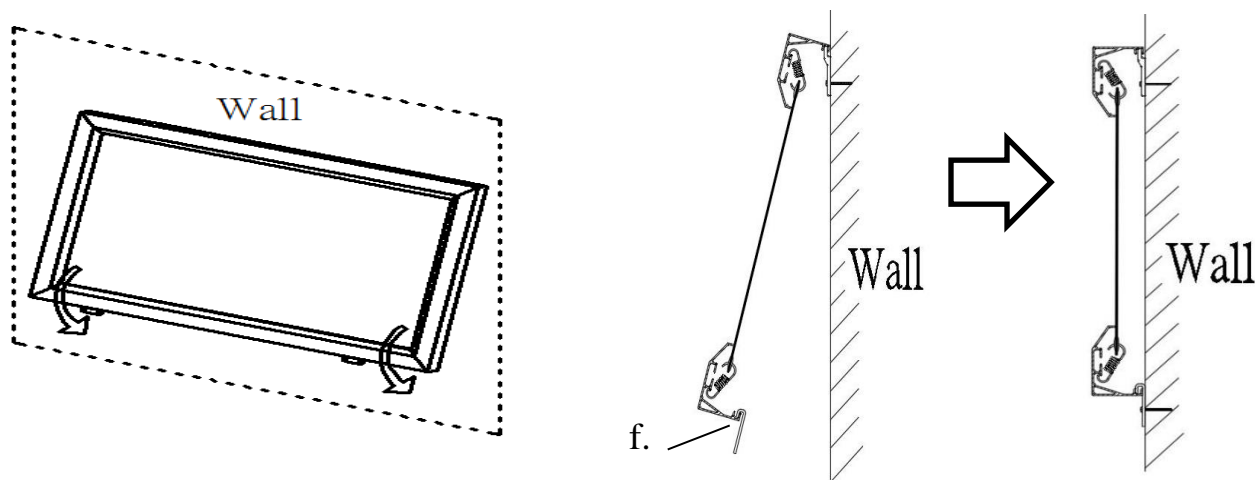

For Technical Support or an Elite Screens contact in your area,

visit www.elitescreens.com